

UVLA

Air grille with drip Wall-mounted air intake/exhaust

UVLA air intake/exhaust vents are designed for use in mechanical or gravity ventilation systems with heat recovery.

The half-dome cowl prevents air back flow from the gusts outside. The louvres force the exhaust air flow down.

The UVLA air intake/exhaust vents have a rubber seal and fitting clamps for easy installation.

Made of stainless steel.

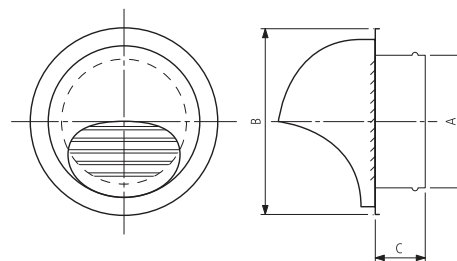

Model	Dimensions, mm				Effective area, m ²	Code	Weight, kg
	D	A	B	C			
UVLA-100	100	97	133	52	0,005	1049638	0,38
UVLA-125	125	120	165	52	0,008	1049639	0,43
UVLA-160	160	155	192	62	0,014	1049640	0,51
UVLA-200	200	195	253	62	0,018	1049641	0,62

ORDER EXAMPLE: Air grille with drip UVLA-100.